

U.S. DEPARTMENT OF HOMELAND SECURITY  
Federal Emergency Management Agency  
National Flood Insurance Program

OMB Control No. 1660-0008  
Expiration Date: 06/30/2026

ELEVATION CERTIFICATE

IMPORTANT: MUST FOLLOW THE INSTRUCTIONS ON PAGES 9-19

Copy all pages of this Elevation Certificate and all attachments for (1) community official, (2) insurance agent/company, and (3) building owner.

| SECTION A - PROPERTY INFORMATION  |                      | FOR INSURANCE COMPANY USE  |
|---|----------------------|--|
| A1. Building Owner's Name: <u>Richard Jackson</u>   |                      | Policy Number: _____   |
| A2. Building Street Address (including Apt., Unit, Suite, and/or Bldg. No.) or P.O. Route and Box No.:<br><u>#8 South Haverford Avenue</u>  |                      | Company NAIC Number: _____   |
| City: <u>City of Margate</u> State: <u>NJ</u> ZIP Code: <u>08402</u>  |                      |  |
| A3. Property Description (e.g., Lot and Block Numbers or Legal Description) and/or Tax Parcel Number:<br><u>Block 109.02 Lot 17</u>   |                      |  |
| A4. Building Use (e.g., Residential, Non-Residential, Addition, Accessory, etc.): <u>Residential</u>  |                      |  |
| A5. Latitude/Longitude: Lat. <u>39.329036</u> Long. <u>-74.500542</u> Horizontal Datum: <input type="checkbox"/> NAD 1927 <input checked="" type="checkbox"/> NAD 1983 <input type="checkbox"/> WGS 84  |                      |  |
| A6. Attach at least two and when possible four clear photographs (one for each side) of the building (see Form pages 7 and 8).  |                      |  |
| A7. Building Diagram Number: <u>7</u>   |                      |  |
| A8. For a building with a crawlspace or enclosure(s):   |                      |  |
| a) Square footage of crawlspace or enclosure(s): <u>706.00</u> sq. ft.  |                      |  |
| b) Is there at least one permanent flood opening on two different sides of each enclosed area? <input checked="" type="checkbox"/> Yes <input type="checkbox"/> No <input type="checkbox"/> N/A   |                      |  |
| c) Enter number of permanent flood openings in the crawlspace or enclosure(s) within 1.0 foot above adjacent grade:<br>Non-engineered flood openings: <u>0</u> Engineered flood openings: <u>4</u>  |                      |  |
| d) Total net open area of non-engineered flood openings in A8.c: <u>0.00</u> sq. in.  |                      |  |
| e) Total rated area of engineered flood openings in A8.c (attach documentation - see Instructions): <u>800.00</u> sq. ft.   |                      |  |
| f) Sum of A8.d and A8.e rated area (if applicable - see Instructions): <u>800.00</u> sq. ft.  |                      |  |
| A9. For a building with an attached garage:   |                      |  |
| a) Square footage of attached garage: <u>0.00</u> sq. ft.   |                      |  |
| b) Is there at least one permanent flood opening on two different sides of the attached garage? <input type="checkbox"/> Yes <input type="checkbox"/> No <input checked="" type="checkbox"/> N/A  |                      |  |
| c) Enter number of permanent flood openings in the attached garage within 1.0 foot above adjacent grade:<br>Non-engineered flood openings: <u>0</u> Engineered flood openings: <u>0</u>   |                      |  |
| d) Total net open area of non-engineered flood openings in A9.c: <u>0.00</u> sq. in.  |                      |  |
| e) Total rated area of engineered flood openings in A9.c (attach documentation - see Instructions): <u>0.00</u> sq. ft.   |                      |  |
| f) Sum of A9.d and A9.e rated area (if applicable - see Instructions): <u>0.00</u> sq. ft.  |                      |  |
| SECTION B - FLOOD INSURANCE RATE MAP (FIRM) INFORMATION   |                      |  |
| B1.a. NFIP Community Name: <u>CITY OF MARGATE</u>   |                      | B1.b. NFIP Community Identification Number: <u>345304</u>                    |
| B2. County Name: <u>ATLANTIC COUNTY</u>   | B3. State: <u>NJ</u> | B4. Map/Panel No.: <u>34001C0434</u> B5. Suffix: <u>F</u>                    |
| B6. FIRM Index Date: <u>07/01/1974</u>  |                      | B7. FIRM Panel Effective/Revised Date: <u>08/28/2018</u>                     |
| B8. Flood Zone(s): <u>AE</u>  |                      | B9. Base Flood Elevation(s) (BFE) (Zone AO, use Base Flood Depth): <u>10</u> |
| B10. Indicate the source of the BFE data or Base Flood Depth entered in Item B9:<br><input type="checkbox"/> FIS <input checked="" type="checkbox"/> FIRM <input type="checkbox"/> Community Determined <input type="checkbox"/> Other: _____                               |                      |  |
| B11. Indicate elevation datum used for BFE in Item B9: <input type="checkbox"/> NGVD 1929 <input checked="" type="checkbox"/> NAVD 1988 <input type="checkbox"/> Other/Source: _____  |                      |  |
| B12. Is the building located in a Coastal Barrier Resources System (CBRS) area or Otherwise Protected Area (OPA)? <input type="checkbox"/> Yes <input checked="" type="checkbox"/> No<br>Designation Date: _____ <input type="checkbox"/> CBRS <input type="checkbox"/> OPA |                      |  |
| B13. Is the building located seaward of the Limit of Moderate Wave Action (LIMWA)? Yes <input type="checkbox"/> No <input checked="" type="checkbox"/>  |                      |  |

# ELEVATION CERTIFICATE

IMPORTANT: MUST FOLLOW THE INSTRUCTIONS ON PAGES 9-19

Building Street Address (including Apt., Unit, Suite, and/or Bldg. No.) or P.O. Route and Box No.:  
#8 South Haverford Avenue

**FOR INSURANCE COMPANY USE**

City: City of Margate State: NJ ZIP Code: 08402

Policy Number: \_\_\_\_\_

Company NAIC Number: \_\_\_\_\_

## SECTION C – BUILDING ELEVATION INFORMATION (SURVEY REQUIRED)

C1. Building elevations are based on:  Construction Drawings\*  Building Under Construction\*  Finished Construction

\*A new Elevation Certificate will be required when construction of the building is complete.

C2. Elevations – Zones A1–A30, AE, AH, AO, A (with BFE), VE, V1–V30, V (with BFE), AR, AR/A, AR/AE, AR/A1–A30, AR/AH, AR/AO, A99. Complete Items C2.a–h below according to the Building Diagram specified in Item A7. In Puerto Rico only, enter meters.

Benchmark Utilized: private Vertical Datum: NAVD88

Indicate elevation datum used for the elevations in items a) through h) below.

NGVD 1929  NAVD 1988  Other: \_\_\_\_\_

Datum used for building elevations must be the same as that used for the BFE. Conversion factor used?  Yes  No

If Yes, describe the source of the conversion factor in the Section D Comments area.

Check the measurement used:

- |   |              |  |
|---|--------------|--|
| a) Top of bottom floor (including basement, crawlspace, or enclosure floor):  | <u>7.4</u>   | <input checked="" type="checkbox"/> feet <input type="checkbox"/> meters |
| b) Top of the next higher floor (see Instructions):   | <u>26.5</u>  | <input checked="" type="checkbox"/> feet <input type="checkbox"/> meters |
| c) Bottom of the lowest horizontal structural member (see Instructions):  | <u>N/A</u>   | <input checked="" type="checkbox"/> feet <input type="checkbox"/> meters |
| d) Attached garage (top of slab):   | <u>N/A</u>   | <input checked="" type="checkbox"/> feet <input type="checkbox"/> meters |
| e) Lowest elevation of Machinery and Equipment (M&E) servicing the building (describe type of M&E and location in Section D Comments area): | <u>14.0'</u> | <input checked="" type="checkbox"/> feet <input type="checkbox"/> meters |
| f) Lowest Adjacent Grade (LAG) next to building: <input type="checkbox"/> Natural <input checked="" type="checkbox"/> Finished              | <u>7.3</u>   | <input checked="" type="checkbox"/> feet <input type="checkbox"/> meters |
| g) Highest Adjacent Grade (HAG) next to building: <input type="checkbox"/> Natural <input checked="" type="checkbox"/> Finished             | <u>7.9</u>   | <input checked="" type="checkbox"/> feet <input type="checkbox"/> meters |
| h) Finished LAG at lowest elevation of attached deck or stairs, including structural support:   | <u>7.8</u>   | <input checked="" type="checkbox"/> feet <input type="checkbox"/> meters |

## SECTION D – SURVEYOR, ENGINEER, OR ARCHITECT CERTIFICATION

This certification is to be signed and sealed by a land surveyor, engineer, or architect authorized by state law to certify elevation information. I certify that the information on this Certificate represents my best efforts to interpret the data available. I understand that any false statement may be punishable by fine or imprisonment under 18 U.S. Code, Section 1001.

Were latitude and longitude in Section A provided by a licensed land surveyor?  Yes  No

Check here if attachments and describe in the Comments area.

Certifier's Name: Paul M. Koelling License Number: NJ24GS 04328800

Title: Professional Land Surveyor

Company Name: Paul Koelling and Associates, LLC

Address: 2161 Shore Road

City: Linwood State: NJ ZIP Code: 08221

Signature:  Date: 7-18-23

Telephone: (609) 927-0279 Ext.: \_\_\_\_\_ Email: PKsurvey1@comcast.net

Place Seal Here

Copy all pages of this Elevation Certificate and all attachments for (1) community official, (2) insurance agent/company, and (3) building owner.

Comments (including source of conversion factor in C2; type of equipment and location per C2.e; and description of any attachments):  
\*A8 & A9.) Smart Vents Model #1540-510 engineered for 200 square inches of net area each....(Municipality and NFIP please see sketch for flood vent compliancy.....Surveyor does not guaranty compliancy due to vague Elevation Certificate Instructions combined with varying interpretations of said Instructions between Municipalities)

\*\*\*C2a.) enclosure (elev 7.4)(see sketch).....elevator pit (elev 6.9)

\*\*\*\*C2e.) exterior air units and interior elevator equipment (elev 26.5+/-)

# ELEVATION CERTIFICATE

IMPORTANT: MUST FOLLOW THE INSTRUCTIONS ON PAGES 9-19

Building Street Address (including Apt., Unit, Suite, and/or Bldg. No.) or P.O. Route and Box No.:  
#8 South Haverford Avenue

City: City of Margate State: NJ ZIP Code: 08402

## FOR INSURANCE COMPANY USE

Policy Number: \_\_\_\_\_  
Company NAIC Number: \_\_\_\_\_

### SECTION E – BUILDING MEASUREMENT INFORMATION (SURVEY NOT REQUIRED) FOR ZONE AO, ZONE AR/AO, AND ZONE A (WITHOUT BFE)

For Zones AO, AR/AO, and A (without BFE), complete Items E1–E5. For Items E1–E4, use natural grade, if available. If the Certificate is intended to support a Letter of Map Change request, complete Sections A, B, and C. Check the measurement used. In Puerto Rico only, enter meters.

Building measurements are based on:  Construction Drawings\*  Building Under Construction\*  Finished Construction  
\*A new Elevation Certificate will be required when construction of the building is complete.

E1. Provide measurements (C.2.a in applicable Building Diagram) for the following and check the appropriate boxes to show whether the measurement is above or below the natural HAG and the LAG.

a) Top of bottom floor (including basement, crawlspace, or enclosure) is: \_\_\_\_\_  feet  meters  above or  below the HAG.

b) Top of bottom floor (including basement, crawlspace, or enclosure) is: \_\_\_\_\_  feet  meters  above or  below the LAG.

E2. For Building Diagrams 6–9 with permanent flood openings provided in Section A Items 8 and/or 9 (see pages 1–2 of Instructions), the next higher floor (C2.b in applicable Building Diagram) of the building is: \_\_\_\_\_  feet  meters  above or  below the HAG.

E3. Attached garage (top of slab) is: \_\_\_\_\_  feet  meters  above or  below the HAG.

E4. Top of platform of machinery and/or equipment servicing the building is: \_\_\_\_\_  feet  meters  above or  below the HAG.

E5. Zone AO only: If no flood depth number is available, is the top of the bottom floor elevated in accordance with the community's floodplain management ordinance?  Yes  No  Unknown The local official must certify this information in Section G.

### SECTION F – PROPERTY OWNER (OR OWNER'S AUTHORIZED REPRESENTATIVE) CERTIFICATION

The property owner or owner's authorized representative who completes Sections A, B, and E for Zone A (without BFE) or Zone AO must sign here. *The statements in Sections A, B, and E are correct to the best of my knowledge*

Check here if attachments and describe in the Comments area.

Property Owner or Owner's Authorized Representative Name: \_\_\_\_\_

Address: \_\_\_\_\_

City: \_\_\_\_\_ State: \_\_\_\_\_ ZIP Code: \_\_\_\_\_

Signature: \_\_\_\_\_ Date: \_\_\_\_\_

Telephone: \_\_\_\_\_ Ext.: \_\_\_\_\_ Email: \_\_\_\_\_

Comments: \_\_\_\_\_

**ELEVATION CERTIFICATE**  
**IMPORTANT: MUST FOLLOW THE INSTRUCTIONS ON PAGES 9-19**

|   |  |
|---|--|
| Building Street Address (including Apt., Unit, Suite, and/or Bldg. No.) or P.O. Route and Box No.:<br>#8 South Haverford Avenue | <b>FOR INSURANCE COMPANY USE</b>                   |
| City: <u>City of Margate</u> State: <u>NJ</u> ZIP Code: <u>08402</u>  | Policy Number: _____<br>Company NAIC Number: _____ |

**SECTION G – COMMUNITY INFORMATION (RECOMMENDED FOR COMMUNITY OFFICIAL COMPLETION)**

The local official who is authorized by law or ordinance to administer the community's floodplain management ordinance can complete Section A, B, C, E, G, or H of this Elevation Certificate. Complete the applicable item(s) and sign below when:

- G1.  The information in Section C was taken from other documentation that has been signed and sealed by a licensed surveyor, engineer, or architect who is authorized by state law to certify elevation information. (Indicate the source and date of the elevation data in the Comments area below.)
- G2.a.  A local official completed Section E for a building located in Zone A (without a BFE), Zone AO, or Zone AR/AO, or when item E5 is completed for a building located in Zone AO.
- G2.b.  A local official completed Section H for insurance purposes.
- G3.  In the Comments area of Section G, the local official describes specific corrections to the information in Sections A, B, E and H.
- G4.  The following information (Items G5–G11) is provided for community floodplain management purposes.
- G5. Permit Number: 20220785 G6. Date Permit Issued: 07/27/26
- G7. Date Certificate of Compliance/Occupancy Issued: 7/27/23
- G8. This permit has been issued for:  New Construction  Substantial Improvement
- G9.a. Elevation of as-built lowest floor (including basement) of the building: 7.4  feet  meters Datum: 88
- G9.b. Elevation of bottom of as-built lowest horizontal structural member: N/A  feet  meters Datum: N/A
- G10.a. BFE (or depth in Zone AO) of flooding at the building site: 10  feet  meters Datum: 88
- G10.b. Community's minimum elevation (or depth in Zone AO) requirement for the lowest floor or lowest horizontal structural member: 10  feet  meters Datum: 88
- G11. Variance issued?  Yes  No If yes, attach documentation and describe in the Comments area.

The local official who provides information in Section G must sign here. *I have completed the information in Section G and certify that it is correct to the best of my knowledge. If applicable, I have also provided specific corrections in the Comments area of this section.*

Local Official's Name: J. A. Galantino Title: CFE

NFIP Community Name: MARGATE

Telephone: 609-422-1771 Ext: \_\_\_\_\_ Email: galantino\_j.a@margate-nj.com

Address: 904 Ainclose Rd

City: MARGATE State: NJ ZIP Code: 08402

Signature: [Signature] Date: 7/26/27

Comments (including type of equipment and location, per C2.e; description of any attachments; and corrections to specific information in Sections A, B, D, E, or H):

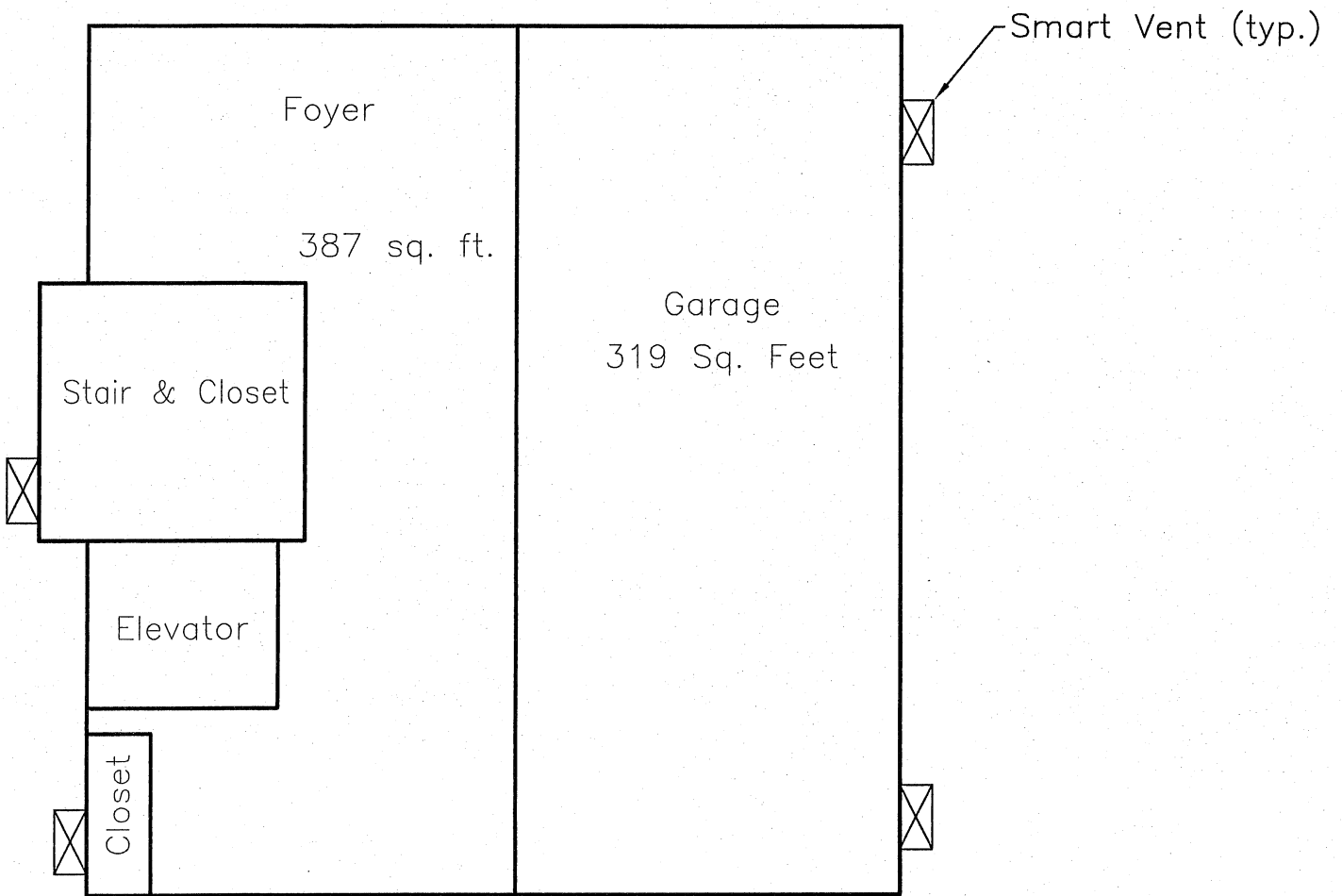

# Building Photographs

See Instructions for Item A6.

For Insurance Company Use:

Building Street Address (including Apt., Unit, Suite, and/or Bldg.) No. or P.O. Route and Box No.

**#8 South Haverford Avenue**

Policy Number

City  
**Margate**

State  
**New Jersey**

ZIP Code  
**08402**

Company NAIC Number

If using the Elevation Certificate to obtain NFIP flood insurance, affix at least two building photographs below according to the instructions for Item A6. Identify all photographs with: date taken; "Front View" and "Rear View"; and, if required, "Right Side View" and "Left Side View." If submitting more photographs than will fit on this page, use the Continuation Page on the reverse.



Front View – Date of Photograph: (See Photo Stamp)

Rear View – Date of Photograph: (See Photo Stamp)



Right Side View – Date of Photograph: (See Photo Stamp)

Left Side View – Date of Photograph: (See Photo Stamp)



Most Widely Accepted and Trusted

ESR-2074

# ICC-ES Evaluation Report

Reissued 02/2021

Revised 04/2021

ICC-ES | (800) 423-6587 | (562) 699-0543 | www.icc-es.org

This report is subject to renewal 02/2023.

DIVISION: 08 00 00—OPENINGS

SECTION: 08 95 43—VENTS/FOUNDATION FLOOD VENTS

REPORT HOLDER:

**SMART VENT PRODUCTS, INC.**

EVALUATION SUBJECT:

**SMART VENT® AUTOMATIC FOUNDATION FLOOD VENTS: MODELS #1540-520;  
#1540-521; #1540-510; #1540-511; #1540-570; #1540-574; #1540-524; #1540-514  
FLOOD VENT SEALING KIT #1540-526**



*"2014 Recipient of Prestigious Western States Seismic Policy Council (WSSPC) Award in Excellence"*



A Subsidiary of

*ICC-ES Evaluation Reports are not to be construed as representing aesthetics or any other attributes not specifically addressed, nor are they to be construed as an endorsement of the subject of the report or a recommendation for its use. There is no warranty by ICC Evaluation Service, LLC, express or implied, as to any finding or other matter in this report, or as to any product covered by the report.*



Copyright © 2021 ICC Evaluation Service, LLC. All rights reserved.

**DIVISION: 08 00 00—OPENINGS**

**Section: 08 95 43—Vents/Foundation Flood Vents**

**REPORT HOLDER:**

SMART VENT PRODUCTS, INC.

**EVALUATION SUBJECT:**

**SMART VENT® AUTOMATIC FOUNDATION FLOOD VENTS: MODELS #1540-520; #1540-521; #1540-510; #1540-511; #1540-570; #1540-574; #1540-524; #1540-514 FLOOD VENT SEALING KIT #1540-526**

**1.0 EVALUATION SCOPE**

**Compliance with the following codes:**

- 2021, 2018, 2015, 2012, 2009 and 2006 *International Building Code*® (IBC)
- 2021, 2018, 2015, 2012, 2009 and 2006 *International Residential Code*® (IRC)
- 2021, 2018 *International Energy Conservation Code*® (IECC)
- 2013 *Abu Dhabi International Building Code* (ADIBC)†

†The ADIBC is based on the 2009 IBC. 2009 IBC code sections referenced in this report are the same sections in the ADIBC.

**Properties evaluated:**

- Physical operation
- Water flow

**2.0 USES**

The Smart Vent® units are engineered mechanically operated flood vents (FVs) employed to equalize hydrostatic pressure on walls of enclosures subject to rising or falling flood waters. Certain models also allow natural ventilation.

**3.0 DESCRIPTION**

**3.1 General:**

When subjected to rising water, the Smart Vent® FVs internal floats are activated, then pivot open to allow flow in either direction to equalize water level and hydrostatic pressure from one side of the foundation to the other. The FV pivoting door is normally held in the closed position by a buoyant release device. When subjected to rising water, the buoyant release device causes the unit to unlatch, allowing the door to rotate out of the way and allow flow. The water level stabilizes, equalizing the lateral forces. Each unit is

fabricated from stainless steel. Smart Vent® Automatic Foundation Flood Vents are available in various models and sizes as described in Table 1. The SmartVENT® Stacking Model #1540-511 and FloodVENT® Stacking Model #1540-521 units each contain two vertically arranged openings per unit.

**3.2 Engineered Opening:**

The FVs comply with the design principle noted in Section 2.7.2.2 and Section 2.7.3 of ASCE/SEI 24-14 [Section 2.6.2.2 of ASCE/SEI 24-05 (2012, 2009, 2006 IBC and IRC)] for a maximum rate of rise and fall of 5.0 feet per hour (0.423 mm/s). In order to comply with the engineered opening requirement of ASCE/SEI 24, Smart Vent FVs must be installed in accordance with Section 4.0.

**3.3 Ventilation:**

The SmartVENT® Model #1540-510 and SmartVENT® Overhead Door Model #1540-514 both have screen covers with 1/4-inch-by-1/4-inch (6.35 by 6.35 mm) openings, yielding 51 square inches (32 903 mm<sup>2</sup>) of net free area to supply natural ventilation. The SmartVENT® Stacking Model #1540-511 consists of two Model #1540-510 units in one assembly, and provides 102 square inches (65 806 mm<sup>2</sup>) of net free area to supply natural ventilation. Other FVs described in this report do not offer natural ventilation.

**3.4 Flood Vent Sealing Kit:**

The Flood Vent Sealing Kit Model #1540-526 is used with SmartVENT® Model #1540-520. It is a Homasote 440 Sound Barrier® (ESR-1374) insert with 21 – 2-inch-by-2-inch (51 mm x 51 mm) squares cut in it. See Figure 4.

**4.0 DESIGN AND INSTALLATION**

**4.1 SmartVENT® and FloodVENT®:**

SmartVENT® and FloodVENT® are designed to be installed into walls or overhead doors of existing or new construction from the exterior side. Installation of the vents must be in accordance with the manufacturer's instructions, the applicable code and this report. Installation clips allow mounting in masonry and concrete walls of any thickness. In order to comply with the engineered opening design principle noted in Section 2.7.2.2 and 2.7.3 of ASCE/SEI 24-14 [Section 2.6.2.2 of ASCE/SEI 24-05 (2012, 2009, 2006 IBC and IRC)], the Smart Vent® FVs must be installed as follows:

- With a minimum of two openings on different sides of each enclosed area.



- With a minimum of one FV for every 200 square feet (18.6 m<sup>2</sup>) of enclosed area, except that the SmartVENT® Stacking Model #1540-511 and FloodVENT® Stacking Model #1540-521 must be installed with a minimum of one FV for every 400 square feet (37.2 m<sup>2</sup>) of enclosed area.
- Below the base flood elevation.
- With the bottom of the FV located a maximum of 12 inches (305.4 mm) above the higher of the final grade or floor and finished exterior grade immediately under each opening.

**4.2 Flood Vent Sealing Kit**

The Flood Vent Sealing Kit Model 1540-526 is used in conjunction with FloodVENT® Model #1540-520. When installed and tested in accordance with ASTM E283, the FV and Flood Vent Sealing Kit assembly have an air leakage rate of less than 0.2 cubic feet per minute per lineal foot (18.56 l/min per lineal meter) at a pressure differential of 1 pound per square foot (50 Pa) based on 12.58 lineal feet (3.8 lineal meters) contained by the Flood Vent Sealing Kit.

**5.0 CONDITIONS OF USE**

The Smart Vent® FVs described in this report comply with, or are suitable alternatives to what is specified in, those codes listed in Section 1.0 of this report, subject to the following conditions:

- 5.1 The Smart Vent® FVs must be installed in accordance with this report, the applicable code and the manufacturer’s installation instructions. In the event of a conflict, the instructions in this report govern.

- 5.2 The Smart Vent® FVs must not be used in the place of “breakaway walls” in coastal high hazard areas, but are permitted for use in conjunction with breakaway walls in other areas.

**6.0 EVIDENCE SUBMITTED**

- 6.1 Data in accordance with the ICC-ES Acceptance Criteria for Mechanically Operated Flood Vents (AC364), dated August 2015 (editorially revised February 2021).
- 6.2 Test report on air infiltration in accordance with ASTM E283.

**7.0 IDENTIFICATION**

- 7.1 The Smart VENT® models and the Flood Vent Sealing Kit described in this report must be identified by a label bearing the manufacturer’s name (Smartvent Products, Inc.), the model number, and the evaluation report number (ESR-2074).
- 7.2 The report holder’s contact information is the following:

**SMART VENT PRODUCTS, INC.**  
 430 ANDBRO DRIVE, UNIT 1  
 PITMAN, NEW JERSEY 08071  
 (877) 441-8368  
[www.smartvent.com](http://www.smartvent.com)  
[info@smartvent.com](mailto:info@smartvent.com)

TABLE 1—MODEL SIZES

| MODEL NAME                         | MODEL NUMBER | MODEL SIZE (in.)   | COVERAGE (sq. ft.) |
|------------------------------------|--------------|--|--------------------|
| FloodVENT®                         | 1540-520     | 15 <sup>3</sup> / <sub>4</sub> " X 7 <sup>3</sup> / <sub>4</sub> " | 200                |
| SmartVENT®                         | 1540-510     | 15 <sup>3</sup> / <sub>4</sub> " X 7 <sup>3</sup> / <sub>4</sub> " | 200                |
| FloodVENT® Overhead Door           | 1540-524     | 15 <sup>3</sup> / <sub>4</sub> " X 7 <sup>3</sup> / <sub>4</sub> " | 200                |
| SmartVENT® Overhead Door           | 1540-514     | 15 <sup>3</sup> / <sub>4</sub> " X 7 <sup>3</sup> / <sub>4</sub> " | 200                |
| Wood Wall FloodVENT®               | 1540-570     | 14" X 8 <sup>3</sup> / <sub>4</sub> "                              | 200                |
| Wood Wall FloodVENT® Overhead Door | 1540-574     | 14" X 8 <sup>3</sup> / <sub>4</sub> "                              | 200                |
| SmartVENT® Stacker                 | 1540-511     | 16" X 16"  | 400                |
| FloodVent® Stacker                 | 1540-521     | 16" X 16"  | 400                |

For SI: 1 inch = 25.4 mm; 1 square foot = m<sup>2</sup>

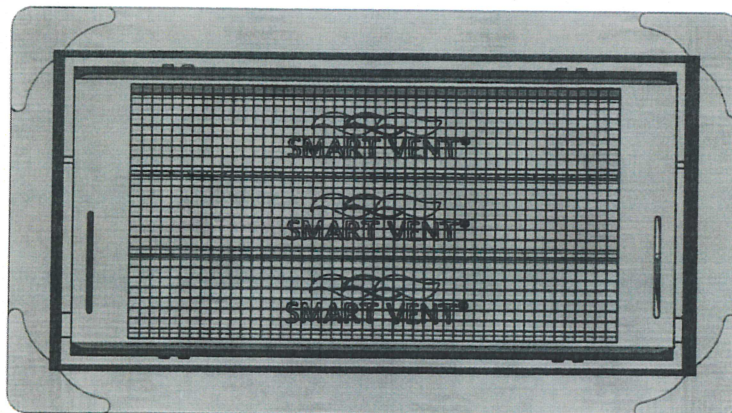

FIGURE 1—SMART VENT: MODEL 1540-510

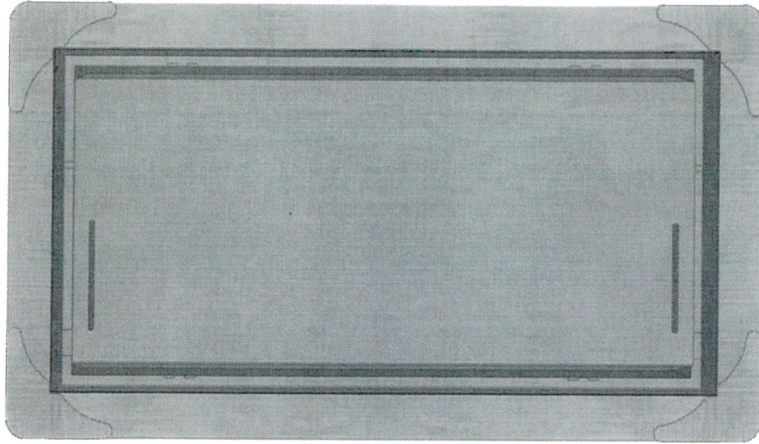

FIGURE 2—SMART VENT MODEL 1540-520

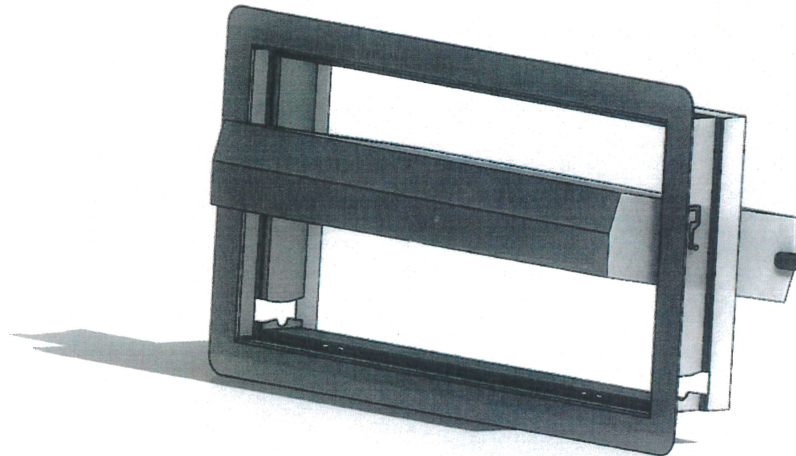

FIGURE 3—SMART VENT: SHOWN WITH FLOOD DOOR PIVOTED OPEN

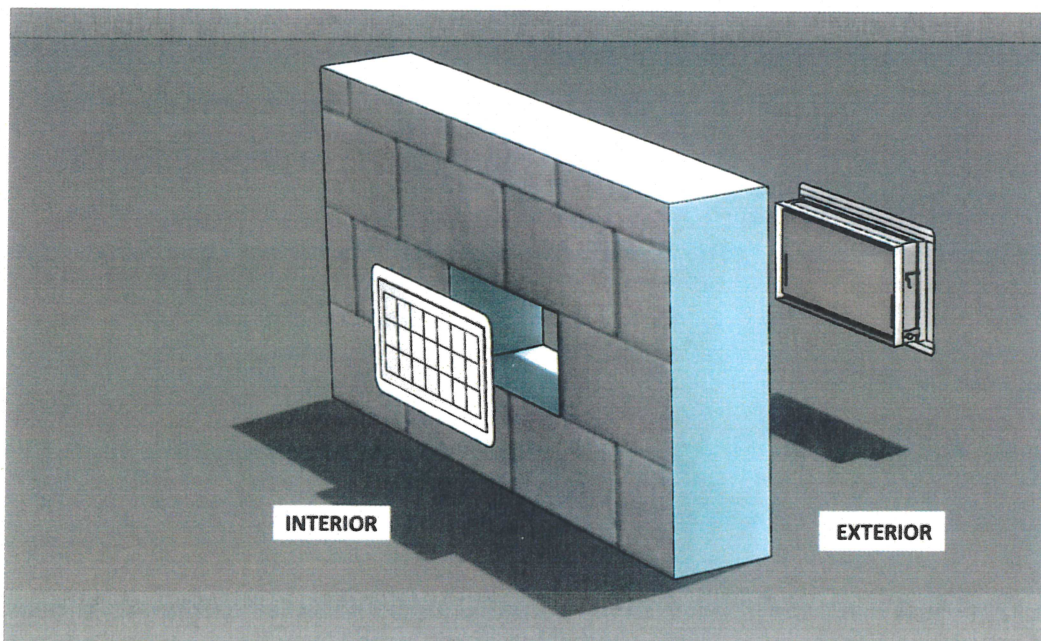

FIGURE 4—FLOOD VENT SEALING KIT